

MDI 18/8 T2 0,55kW (300718400)

GENERAL DATA



MEDIUM PRESSURE FAN WITH FORWARD IMPELLER AND IN STAINLESS STEEL CONSTRUCTION

MANUFACTURING FEATURES:

- Welded stainless steel AISI 304 housing.
- Stainless steel simple inlet forward curved impeller.
- Standard asynchronous squirrel-cage motor with IP-55 protection and Class F insulation. Manufactured with standard voltages: 230V 50Hz for single phase motors, 230/400V 50Hz for three phase motors.
- Available positions (to be indicated in case of order): LG270, LG0, LG45, LG90, LG135, LG180, LG225, LG315, RD0, RD45, RD90, RD135, RD180, RD225, RD270, RD315.
- The indicated codes correspond to the model in position LG270.

APPLICATIONS:

Designed for inline installation, they are suitable for:

- Industrial applications, extraction or injection of air.
- Cooling of machines and parts.
- Clean air transport.
- Corrosive air transport.
- Maximum working temperature: carried air: 130°C, ambient: 1ph 50°C, 3ph 60°C.

UNDER REQUEST:

- 60Hz fans and special voltages.
- 2 speed motors (three phase motors).

PERFORMANCE CURVE

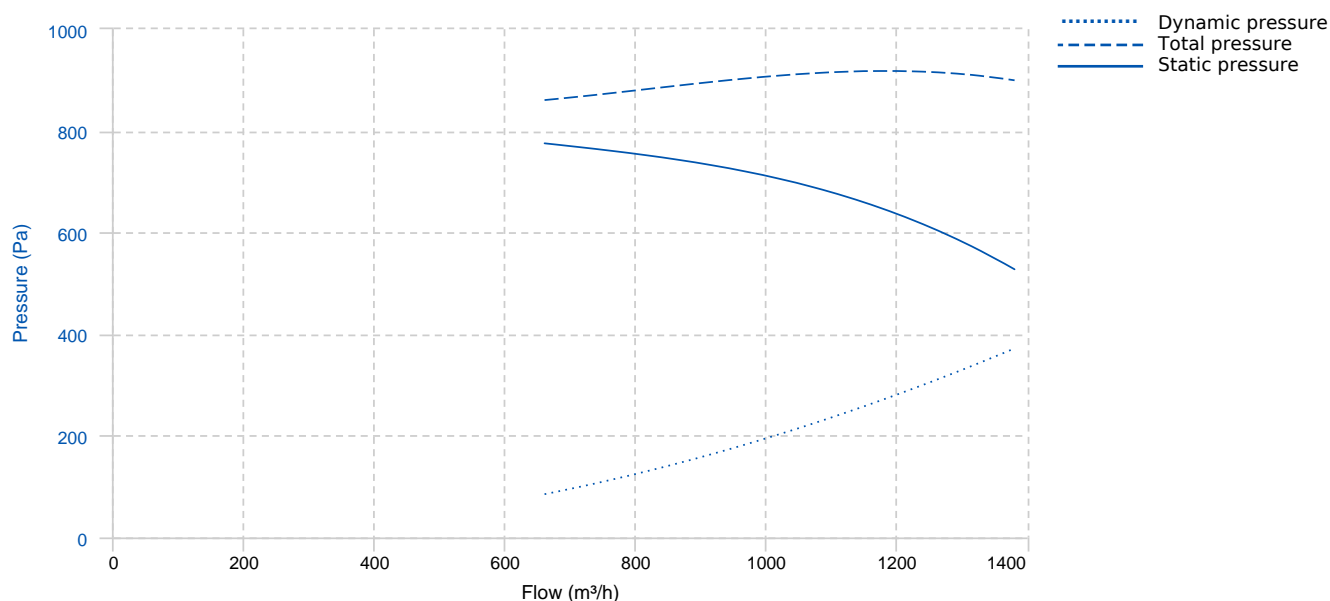

TECHNICAL DATA

| Fan | | | | | | | |
|-------|---------|----------------|---------|---------------|-----------|---------------|--------|
| RPM | 2800 | Approx. weight | 10.2 kg | Max. Flow | 1380 m³/h | | |
| Motor | | | | | | | |
| Power | 0,55 kW | RPM | 2800 | I max. (230V) | 2,23 A | I max. (400V) | 1,29 A |
| Size | 71 | Approx. weight | 6.8 kg | | | | |

DIMENSIONS

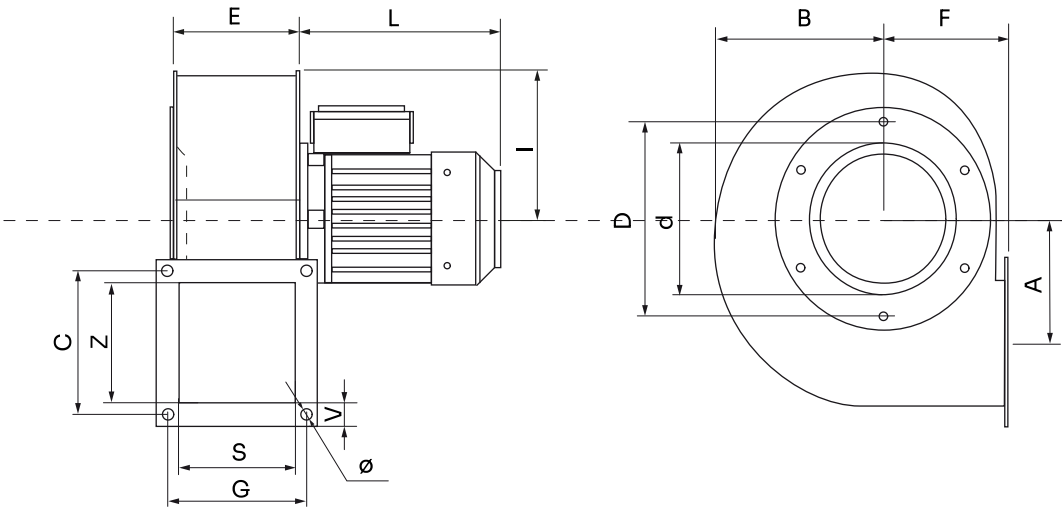

| Dimensions (mm) | | | | | | | | | |
|-----------------|------|---|-----|---|-----|---|------|---|-----|
| A | 115 | B | 158 | C | 133 | D | 200 | E | 114 |
| F | 120 | G | 133 | I | 134 | L | 215 | S | 110 |
| V | 22.5 | Z | 110 | d | 140 | Ø | 9x16 | | |

WIRING DIAGRAM

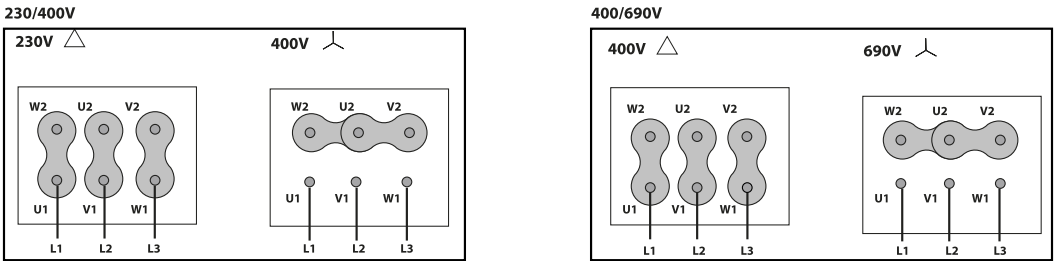

ACCESSORIES



SAFETY SWITCH
INT 25 3P A
REF: INT253PA



STAINLESS STEEL INLET PROTECTION GUARD
FOR CENTRIFUGAL FANS
RAI 18/8
REF: 300716902



FREQUENCY SPEED CONTROLLER
SFC 230 I 2,5A *
REF: SFC230I003



FREQUENCY SPEED CONTROLLER
SFC 400 III 2,2A *
REF: SFC400III2



ACOUSTIC CABINS FOR CENTRIFUGAL FANS
AB (GENERIC)

SPARE PARTS

| | Code | Model | Qty |
|---|-----------|-----------------------------|-----|
| 4 | 721001032 | MOTOR 0,55kW T2 B5 230/400V | x1 |